

ALEKO®

Outdoor Sturdy Child Swing Seat with 2 Swings



SKU: BSW03

ALEKO®

www.ALEKO.com

SKU# BSW03



Dual Swing Set
FOR CHILDREN AGED 3 TO 10 YEARS

SAFETY GUIDELINES

Warnings

Only for domestic use. This product has not been designed for commercial use in play centers, nurseries etc.

Only suitable for outdoor use.

Not for children with a body weight over 45kg. Only one child per seat at any one time.

Not for children under 3 years due to small component which may cause choking hazard.

This equipment must be assembled and checked by an adult

Adult supervision is required at all times.

Check all nuts, bolts and fittings for tightness and tighten if required.

Check all coverings for bolts and sharp edges and replace when required.

Check swing seats, chain, ropes and other means of attachments for evidence of deterioration. Replace when required in accordance with the manufacturers instructions.

Place the product on level surface at least 2 metres from any structure or obstruction such as a fence, garage, house, wall, overhanging branches, laundry line or electrical wires.

The items **MUST** be anchored firmly into the ground

DO NOT install the product over concrete, asphalt or any hard surface.

DO NOT orientate the product directly towards the sun

Leave all fittings finger tight until assembly is complete, for ease of construction. Then tighten firmly.

Children should not wear cycle helmets whilst on this equipment

Do not allow children to stand on the swing or glider seats

Do not allow the children to get off the swings or glider while they are still moving

Do not twist swing ropes or wrap them over the top bar

Do not allow loose, hooded or baggy clothes to be worn since children can get trapped and may be unable to free themselves.

Do not allow children to climb on parts of this equipment intended for this purpose

Do not allow children to wander into the play area when the equipment is in use

Do not allow children to slide head first down the chute or walk up the chute

Glider and swings must not exceed an angle of 60 degrees from the ground

Regularly check the item for wear and damage, removing the item from use when necessary until replacement parts are fitted.

Failure to assemble and maintain this item as per instruction may cause injury to the user.

The minimum clearance between the swing seat and ground level should be 350mm.

Please contact our customer services department if you have any problems.

Inspect all parts of this product every 6 months following purchase. If any parts look worn or you find any problems, please contact us for replacements and do not use product until problem has been corrected. Hedstrom recommends replacing the plastic swing rope clamps every 2 years even if there is no sign of deterioration.

Do not modify this item.

Please keep the instructions in a safe place for future reference

Conforms to EN71

SWING PARTS LIST

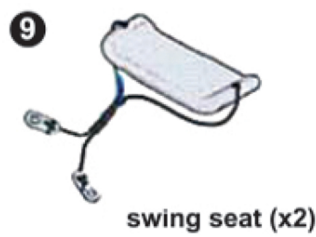
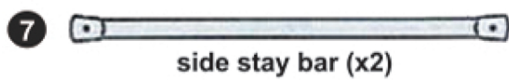
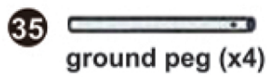
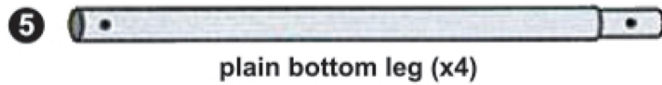
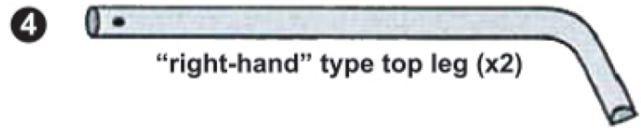
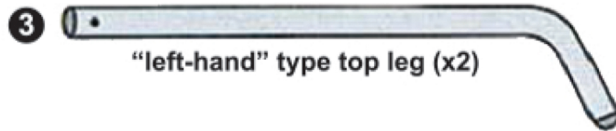
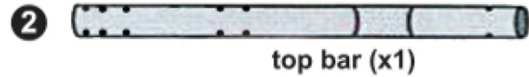
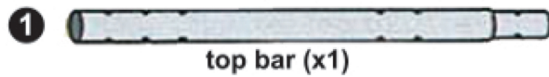

IMPORTANT: Make sure you read the safety notice on the front page and always supervise children while they are playing on the equipment. Once assembly is completed carefully check equipment. In the unlikely event that you do find any problems, please contact us. Do not allow children to use this product until the problem has been corrected.

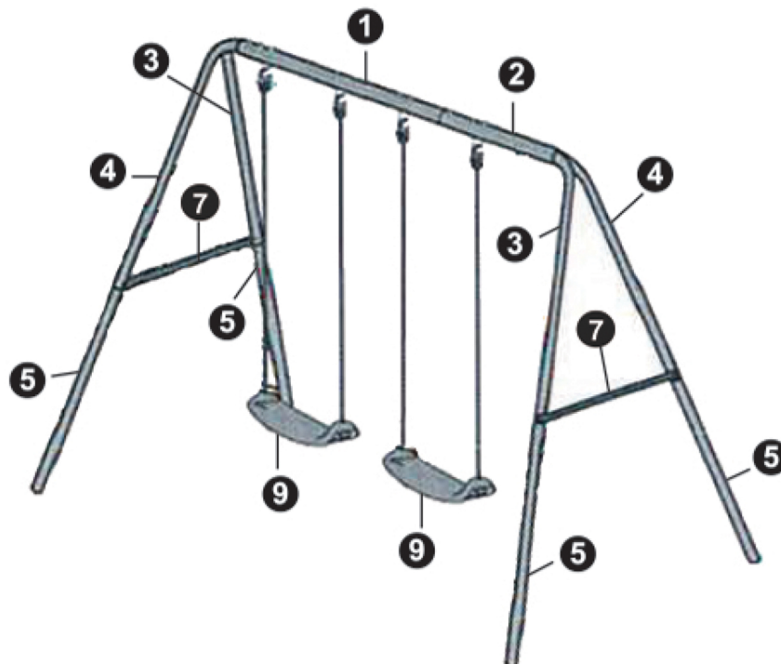

Frame Assembly

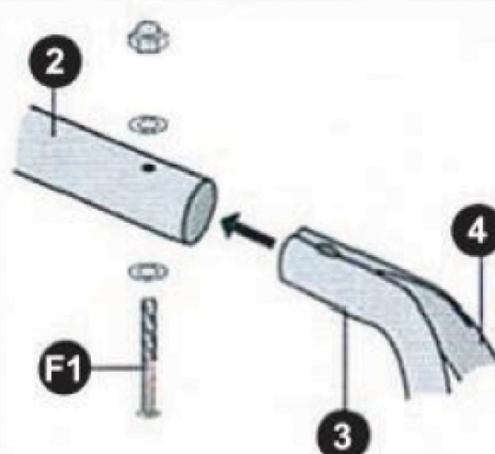
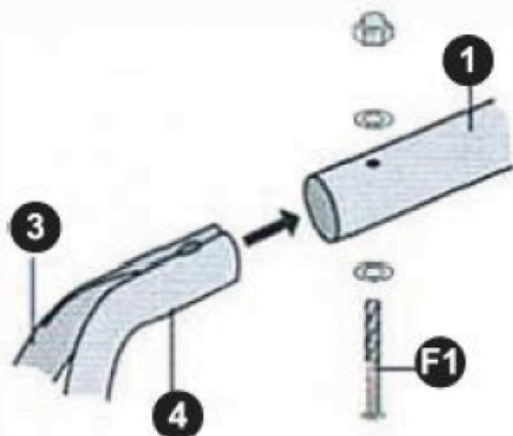

BEFORE ASSEMBLING: Please read and abide by all Safety Guidelines, and confirm all necessary parts are included by referencing parts list on page 1.

Step 1. Place together the short curved ends of the Left-Hand Top Leg and Right-Hand Top Leg and insert into the Top Bar.

Step 2. Place 1 F1 fastener in vertical hole in Top Bar assembly and tighten securely.

Swing Assembly

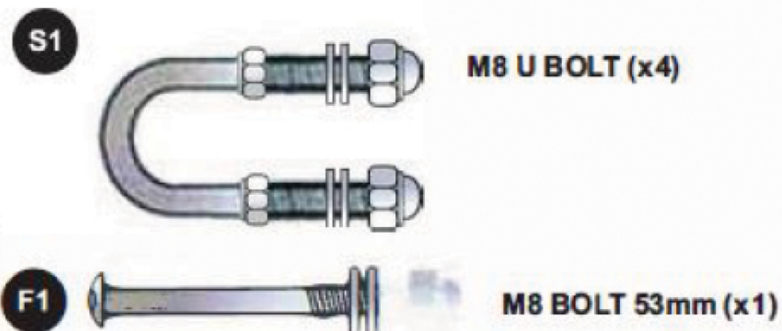

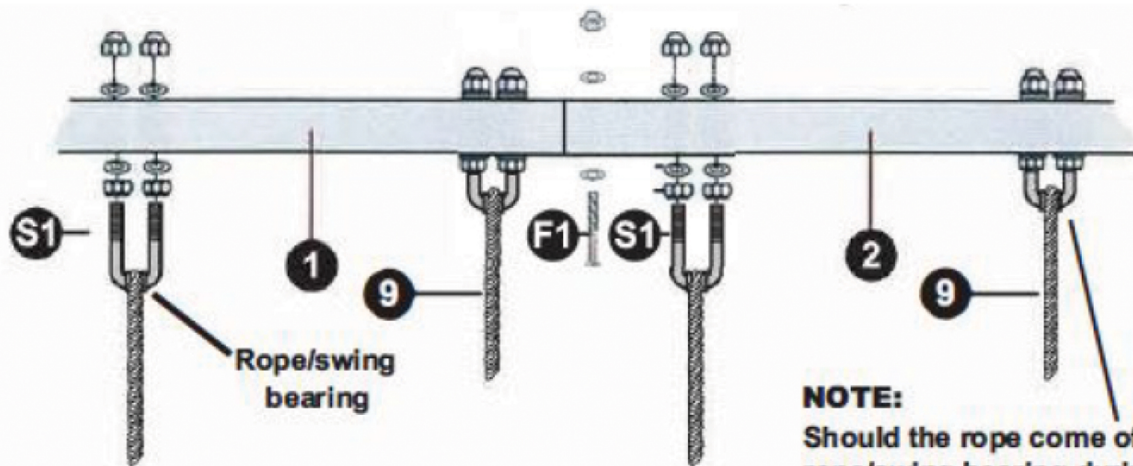

Remember to attach the rope/swing bearing to the U-bolt

NOTE:

Should the rope come off the rope/swing bearing during use please replace back on top of the rope/swing bearing.

Step 1. Completely disassemble S1 U-Bolts then place u-shaped bolt through the hole in the bearing assembly found at the end of the Swing Ropes.

Step 2. Tighten open-ended S1 nut down onto u-shaped bolt, place 1 S1 washer on each end of the bolt and insert into Top Bar through 2 sets of vertical holes. Ensure washer placement between nuts and Top Bar.

Step 3. Place 1 S1 washer on the exposed threaded ends of the S1 bolt, then attach S1 cap nuts and tighten down. Repeat for both sets of Swing Ropes.

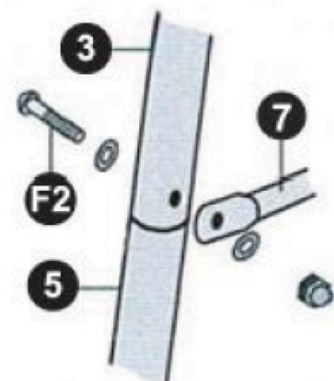
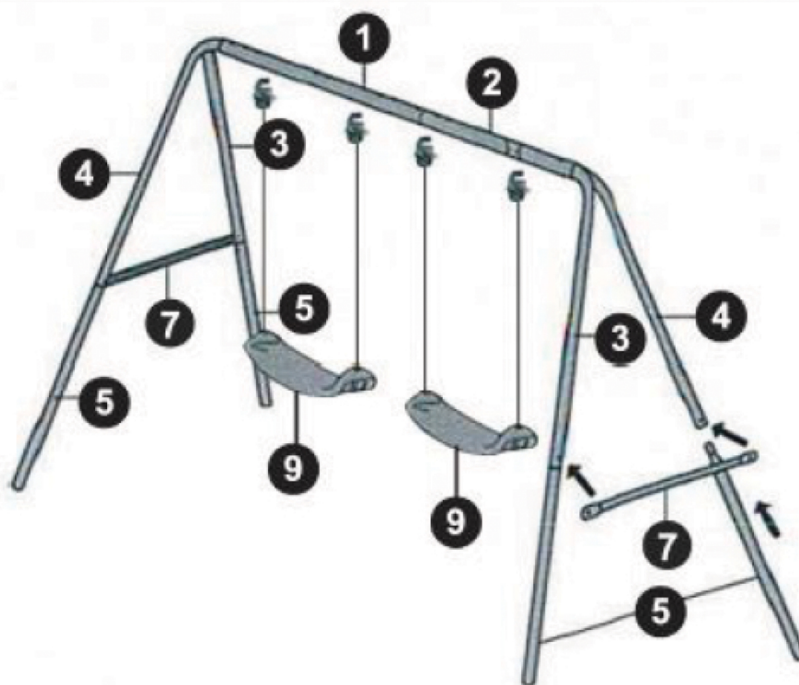

Step 4. Insert 1 Bottom Leg into the open end of each of the 4 Top Legs. Place a F2 fastener into each of the holes at the junction, making sure the exposed threaded end is pointed away from the Swings.

Step 5. Place Side Stay Bar over the exposed fastener ends so that the flat side of the Stay Bar ends is in contact with the Top/Lower Leg assembly.

Step 6. Tighten F2 nut down onto Side Stay Bar.

Anchoring Swing Set to Ground

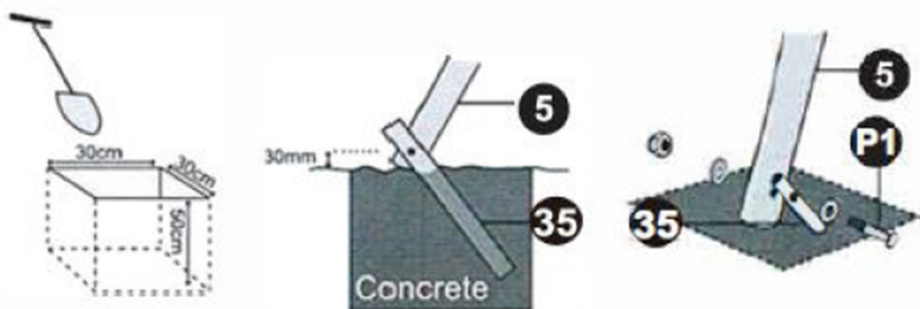

Step 1. Attach Ground Pegs to all 4 Nest Swing Bottom Legs using P1 fasteners.

Step 2. Place assembled Swing Set in desired location and dig a footing hole, measuring 12" (30cm) Long x 12" (30cm) Wide x 20" (50cm) Deep, at the base of each support leg.

Step 3. Prepare and pour concrete into the footing holes following concrete manufacturer's instructions. Fully fill footing holes to be level with ground surface.

Step 4. While Concrete is still wet, angle Ground Pegs toward swingset Top Bar at roughly 120-degrees, then insert Ground Pegs into concrete footing, making sure Swingset Bottom Legs do not sink below ground surface (utilize concrete set time information). Use temporary support made from wood or other material if necessary to prevent sinkage.

Swing Set will be ready for use once concrete is fully set and cured (consult concrete manufacturer's instructions).

ALEKO®

8307 S 192nd St Kent, WA 98032

Phone: 833-926-2323

hello@aleko.com

www.ALEKO.com